

National Gallery of Art

Washington, D.C. 20565

Official Business

Penalty for Private Use, \$300

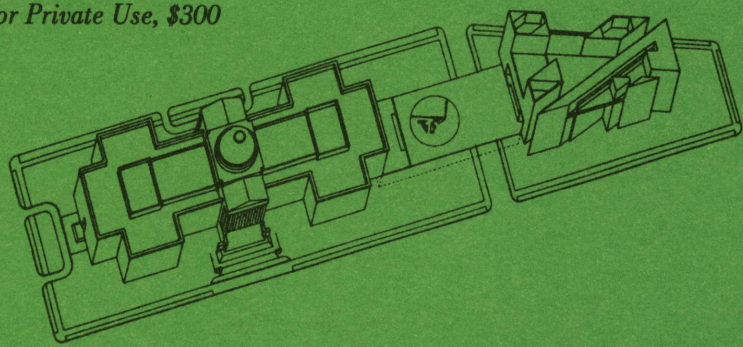

CALENDAR OF EVENTS

March 1982

**MONDAY,
March 1
through
SUNDAY,
March 7**

Tours and Paintings of the Week

*Rosenwald Exhibition:
15th to 17th Centuries*
Tues. through Sat. 1:00
Sun. 2:30
East Building
Ground Floor Lobby

Jan Steen
The Dancing Couple
(Widener Collection)
Tues. through Sat. 12:00
& 2:00; Sun. 3:30 & 6:00
West Building
Gallery 50



Introductory Tours

*Introduction to the East
Building's Collection*
Mon. through Sat. 11:00
Sun. 1:00
East Building
Ground Floor Lobby

*Introduction to the West
Building's Collection*
Mon. through Sat. 3:00
Sun. 5:00
West Building
Rotunda

Films

Francisco Goya (26 min.)
and *Daumier, Paris and
the Spectator* (18 min.)
Tues. through Fri. 12:30
Sun. 1:15

Lust for Life (life of
Vincent van Gogh—
122 min.) Sat. 12:30

Rodin: The Gates of Hell
(53 min.)
Mon. through Fri. 11:00
2:00 & 3:00
Sat. 11:00, 3:00 & 4:00
Sun. 12:15 & 6:00

East Building
Auditorium

Sunday Lectures

*Cimabue & Co., Ltd.
An Historical Evaluation
of Styles in Thirteenth-
Century Tuscan Painting*

Speaker:
Jens T. Wolleson
Professor
Institute of Art History
University of Munich
Germany

Sunday 4:00

East Building
Auditorium

Sunday Concerts

Fernando Laires, *Pianist*

West Building
East Garden Court 7:00

**MONDAY,
March 8
through
SUNDAY,
March 14**

*Rosenwald Exhibition:
18th to 20th Centuries*
Tues. through Sat. 1:00
Sun. 2:30
East Building
Ground Floor Lobby

Henri Fantin-Latour
Still Life
(Chester Dale Collection)
Tues. through Sat. 12:00
& 2:00; Sun. 3:30 & 6:00
West Building
Gallery 89



*Introduction to the East
Building's Collection*
Mon. through Sat. 11:00
Sun. 1:00
East Building
Ground Floor Lobby

*Introduction to the West
Building's Collection*
Mon. through Sat. 3:00
Sun. 5:00
West Building
Rotunda

Mary Cassatt (30 min.)
and *Käthe Kollwitz*
(19 min.)
Tues. through Fri. 12:30
Sun. 1:15

Lust for Life (life of
Vincent van Gogh—
122 min.) Sat. 12:30

Rodin: The Gates of Hell
(53 min.)
Mon. through Fri. 11:00,
2:00 & 3:00
Sat. 11:00, 3:00 & 4:00
Sun. 12:15 & 6:00

East Building
Auditorium

*Giants in the Piazza:
The Sculpture of the
Piazza della Signoria
in Florence*

Speaker:
Kathleen Weil-Garris
Professor of Fine Arts
Institute of Fine Arts
New York University
New York

Sunday 4:00

East Building
Auditorium

Glenda Maurice
Mezzo Soprano
David Garvey, *Pianist*

West Building
East Garden Court 7:00

**MONDAY,
March 15
through
SUNDAY,
March 21**

*Renaissance Painting:
Parallels to the
Rosenwald Exhibition*
Tues. through Sat. 1:00
Sun. 2:30
West Building
Rotunda

Jan Lys
The Satyr and the Peasant
(Widener Collection)
Tues. through Sat. 12:00
& 2:00; Sun. 3:30 & 6:00
West Building
Gallery 45



*Introduction to the East
Building's Collection*
Mon. through Sat. 11:00
Sun. 1:00
East Building
Ground Floor Lobby

*Introduction to the West
Building's Collection*
Mon. through Sat. 3:00
Sun. 5:00
West Building
Rotunda

Die Brücke (German
Expressionist movement—
26 min.) and
Van Gogh (written by Alain
Resnais—17 min.)
Tues. through Fri. 12:30
Sun. 1:15

Moulin Rouge (life of
Toulouse-Lautrec—
119 min.) Sat. 12:30

Rodin: The Gates of Hell
(53 min.)
Mon. through Fri. 11:00
2:00 & 3:00
Sat. 11:00, 3:00 & 4:00
Sun. 12:15 & 6:00

East Building
Auditorium

What is Folk Art?

Speaker:
Beatrice T. Rumford
Vice President, Museums
The Colonial Williamsburg
Foundation
Williamsburg

Sunday 4:00

East Building
Auditorium

National Gallery Orchestra
Richard Bales, *Conductor*
Robin McCabe, *Pianist*

West Building
East Garden Court 7:00

**MONDAY,
March 22
through
SUNDAY,
March 28**

*Baroque and Modern
Painting: Parallels to the
the Rosenwald Exhibition*
Tues. through Sat. 1:00
Sun. 2:30
West Building
Rotunda

Mary Cassatt
The Boating Party
(Chester Dale Collection)
Tues. through Sat. 12:00
& 2:00; Sun. 3:30 & 6:00
West Building
Gallery 86



*Introduction to the East
Building's Collection*
Mon. through Sat. 11:00
Sun. 1:00
East Building
Ground Floor Lobby

*Introduction to the West
Building's Collection*
Mon. through Sat. 3:00
Sun. 5:00
West Building
Rotunda

*Gauguin in Tahiti: The
Search for Paradise*
(51 min.)
Tues. through Fri. 12:30
Sun. 1:15

Moulin Rouge (life of
Toulouse-Lautrec—
119 min.) Sat. 12:30

Rodin: The Gates of Hell
(53 min.)
Mon. through Fri. 11:00
2:00 & 3:00
Sat. 11:00, 3:00 & 4:00
Sun. 12:15 & 6:00

East Building
Auditorium

*Goya and the
Eloquent Fragment*

Speaker:
Fred Licht
Professor of Art History
Boston University
Boston

Sunday 4:00

East Building
Auditorium

Robert Battey, *Cellist*
Edward Newman, *Pianist*

West Building
East Garden Court 7:00

National Gallery of Art

Washington, D.C. 20565

The telephone number for general information is (202) 737-4215.

The Gallery is located between 3rd and 7th Streets, Northwest, on Constitution Avenue. The East and West Buildings are connected by an all-weather underground passage with a moving walkway. Entrances to the West Building are on the Mall, on Constitution Avenue at 6th Street, which has a ramp for the handicapped, and off 4th Street. The entrance to the East Building is on 4th Street off National Gallery Plaza and also has a ramp for the handicapped.

Each week, a black-and-white photograph or color reproduction or postcard of the Painting of the Week is for sale in the Publications area on the West Building's ground floor. Descriptive text is available at no charge.

Gallery Hours: The Gallery is open 10 a.m. to 5 p.m. Monday through Saturday. Sunday hours remain the same throughout the year: 12 noon to 9 p.m.

EXHIBITIONS

March 1982

Continuing Exhibitions

Lessing J. Rosenwald: Tribute to a Collector

February 21-May 9, 1982
Ground level
East Building

This memorial exhibition contains 100 old master and modern prints and drawings selected from over 22,000 graphic works collected by Lessing J. Rosenwald, a founding benefactor of the National Gallery of Art. The vast scope of Rosenwald's interests as a collector from the mid-1920s until his death in 1979 is reflected in the diversity of the exhibition, which includes works from the 13th through the 20th centuries.

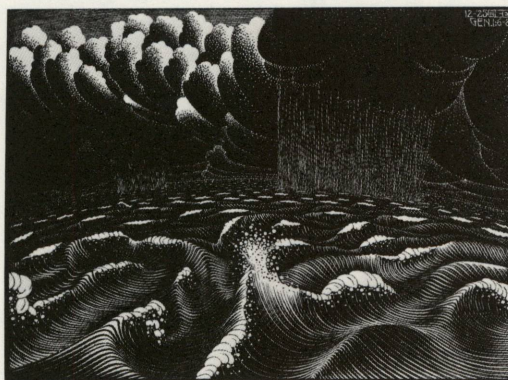

Genesis: The Second Day of Creation
ESCHER
National Gallery of Art
Lessing J. Rosenwald Collection

The pieces on view demonstrate this scope and include a medieval manuscript illumination, engravings and a woodcut by Albrecht Dürer, etchings, drypoints, and a drawing by Rembrandt van Rijn, and engravings and watercolors by William Blake. Prints by Toulouse-Lautrec, Mary Cassatt, and Pablo Picasso are also included.

Accompanying the exhibition is a fully illustrated catalogue by Ruth E. Fine, Curator, Department of Graphic Arts, and organizer of the exhibition.

Rodin Rediscovered

Upper level and Mezzanine
extended through April 11, 1982
Ground level and Concourse
extended through May 2, 1982

On view are almost 250 examples of sculpture and drawings by the French artist Auguste Rodin (1840-1917). Also exhibited are close to 100 contemporary photographs of Rodin's sculpture. The works have been lent by over 40 European and American public and private collections.



La Défense (The Call to Arms)
RODIN
The Fine Arts Museums of San Francisco
Gift of Mrs. Alma deBretteville Spreckles

The exhibition has been made possible by generous support from the IBM Corporation. It has been extended to meet popular demand through the courtesy of the lenders.

A 45-minute recorded tour is available in English or French.

A new film, *Rodin: The Gates of Hell*, produced by Iris Cantor and David Saxon, documents the first and only lost-wax casting of the *Gates* at the Coubertin Foundry, France. (Please check the reverse side for the times when the film will be shown.)

Between Continents-Between Seas: Precolumbian Art of Costa Rica

Through May 9, 1982
Concourse level
East Building

This is the first comprehensive exhibition of Costa Rican Precolumbian treasures to travel outside of Central America. The exhibition includes ceremonial, decorative, and utilitarian objects in gold, jade, and ceramic and volcanic stone, dating from c. 500 B.C. to the 16th century A.D.



Female Figure
Instituto Nacional de Seguros
Photo: Dirk Bakker
The Detroit Institute of Arts

The exhibition was organized by the Detroit Institute of Arts. A fully illustrated catalogue containing 100 color plates and essays by noted experts in the field is available at Gallery sales shops.

A 10-minute film about the exhibition produced by the Detroit Institute of Arts is being shown continuously in the East Building's audiovisual theater adjacent to the exhibition. Also available is a 40-minute recorded tour.

The Four Moments of the Sun: Kongo Art in Two Worlds

Extended through May 30, 1982
Ground level
East Building



Nsiba (biludi)
Private Collection

This exhibition, the first to focus upon the funerary art of the Central African civilization of Kongo in Bas-Zaïre, includes sculpture in stone, wood, and cloth, as well as richly incised terra-cotta grave markers never before presented in North America.

A fully illustrated catalogue containing four major essays on Kongo art is available, as is a brochure describing each work in the exhibition.

Garden Café

West Building

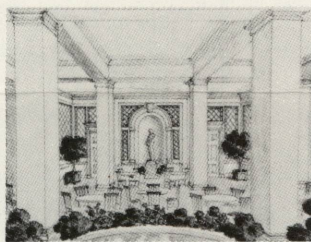

Garden Café (crayon rendering)

The Garden Café, located in the Central Lobby, a recently renovated area on the ground floor of the National Gallery's West Building, opens this month. As its name implies, the café, situated around a central fountain, has a garden theme and offers light menu selections such as soups, sandwiches, and desserts.

New Publications by National Gallery Staff

Jan Vermeer offers a comprehensive study of the works of this 17th-century Dutch master. It is the latest publication by Arthur K. Wheelock, Jr., Curator of Dutch and Flemish paintings at the National Gallery of Art, and is available at the Gallery bookstores.



A Heritage of American Paintings from the National Gallery of Art is a popular introduction to American art by William James Williams, a National Gallery staff lecturer. The book can be purchased at the Gallery bookstores.